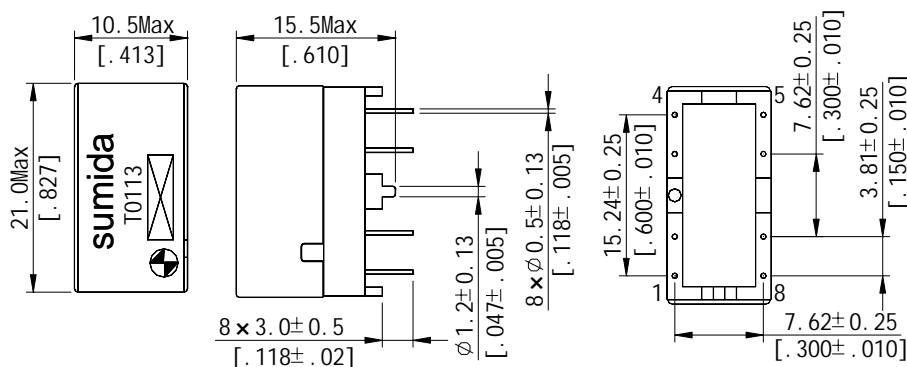
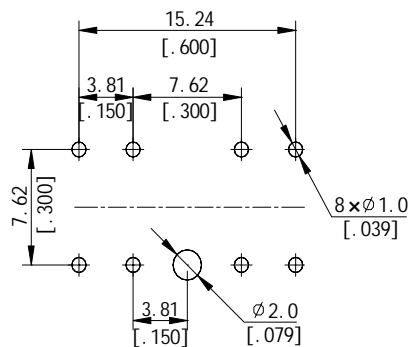
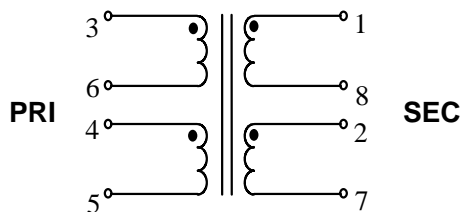

**Type: BM2015**
**Product Description**

- 21.0 × 10.5mm Max.(L × W), 15.5mm Max. Height.
- Operating frequency: 4 ~ 21MHz.

**Feature**

- HomePlug shielded line isolation transformer with a metal cap glued on the top.
- Ideally for powerline networking applications in set-top box and other CPE data networking devices.
- RoHS Compliance.

**Dimensions(mm)**

**Land Pattern (mm)**

**Schematics(Bottom)**

**Specification(Part Number:T0113)**

Characteristics	Specifications	Measuring conditions
Inductance (Ls) (1-8)	160 $\mu$ H Min	100kHz, 0.1V,
Inductance (Ls) (4-5)	2.8 $\mu$ H Min	100kHz, 0.1V,
Turns ratio (T/R) (1-8): (2-7)	6 : 1 ( ± 5%)	10kHz, 0.1V
Turns ratio (T/R) (1-8): (3-6)	6 : 1 ( ± 5%)	10kHz, 0.1V
Turns ratio (T/R) (1-8): (4-5)	6 : 1 ( ± 5%)	10kHz, 0.1V
D.C.R. (1-8)	70m Max	at 25
D.C.R. (2-7)	19m Max	at 25
D.C.R. (3-6)	19m Max	at 25
D.C.R. (4-5)	19m Max	at 25